



USER GUIDE

Neakasa PowerScrub II **FLOOR CLEANER**

- FR GUIDE DE L'UTILISATEUR
- DE BEDIENUNGSANLEITUNG
- IT GUIDA UTENTE
- ES GUÍA DEL USUARIO
- TUR KULLANICI REHBERİ



TUTORIAL VIDEO

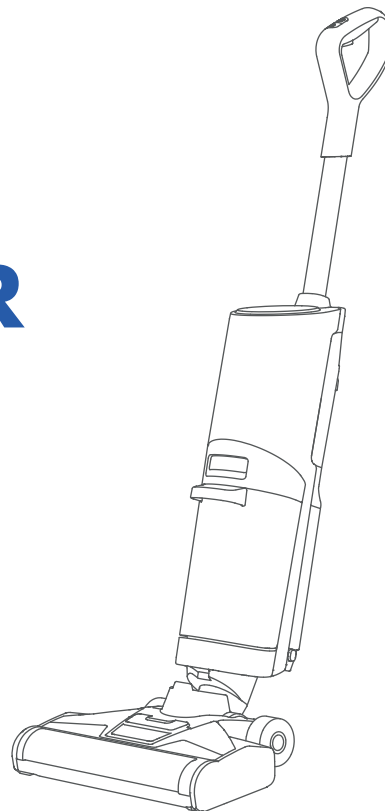

User Guide

• Safety Instructions	1
• Package Includes	2
• Product View	3-5
• Get Started	6-10
• Care and Maintenance	11-15
• Disposal of Battery	16
• Specifications	16
• Troubleshooting	17-18
• Customer Support	19
• Warranty	20

Bedienungsanleitung

• Sicherheitshinweise	41
• Lieferumfang	42
• Produktbeschreibung	43-45
• Anwendung	46-50
• Wartung und Pflege	51-55
• Entsorgung des Akkus	56
• Ausführung	56
• Störung beseitigt	57-58
• Kundendienst	59
• Garantie	60

Guía Del Usuario

• Precaución	81
• El paquete incluye	82
• Vista del producto	83-85
• Empieza a usar	86-90
• Cuidado y mantenimiento	91-95
• Manejo de la batería	96
• Especificación	96
• Solución de problemas	97-98
• Atención al cliente	99
• Garantía	100

Guide De L'utilisateur

• Instructions de sécurité	21
• Le forfait comprend	22
• Vue du produit	23-25
• Démarrer	26-30
• Entretien et maintenance	31-35
• Traitement de la batterie	36
• Spécifications	36
• Dépannage	37-38
• Assistance à la clientèle	39
• Garantie	40

Guida Utente

• Attenzione	61
• La confezione include	62
• Vista del prodotto	63-65
• Inizia a usare	66-70
• Cura e manutenzione	71-75
• Smaltimento della batteria	76
• Specifica	76
• Risoluzione dei problemi	77-78
• Servizio Clienti	79
• Garanzia	80

Kullanici Rehberi

• Güvenlik Talimatları	101
• Paket İçeriği	102
• Ürün Görünümü	103-105
• Temizleyiciyi Şarj Etme	106-110
• Bakım ve Onarım	111-115
• Pilin Atılması	116
• Özellikler	116
• Sorun Giderme	117-118
• Müşteri Desteği	119
• Garanti	120

Safety Instructions

- This product is for home use. Please do not use it outdoors.
- Do not disassemble or repair the cleaner by yourself.
- Do not use the product in an environment with a risk of fire or explosion.
- Do not use cleaner to pick up flammable materials, such as gasoline, lighter fluid.
- Do not use cleaner to pick up toxic material.
- Do not use cleaner to pick up paint, pigments, and corrosive liquids.
- Do not use cleaner to pick up sharp objects, such as nails, screws, glass.
- Do not use cleaner to pick up things that are burning or smoking, such as hot ashes, cigarettes.
- Do not wash or soak the main body or electronic accessories in water.
- Do not use it as a toy. Close attention is necessary when used by or near children.
- Do not touch the charging plug and charging station with wet hands.
- Do not expose the product to direct sunlight for a long time.
- Do not place cleaner near cigarette butts, lighters, or other open fires.
- When the metal part of the power plug is dusty, please wipe it with a dry cloth.
- The power adapter is applied to a 100-240V AC voltage. Please plug into the socket properly and keep away from the children.
- The operating temperature of the product ranges from 0°C-40°C; please do not use it in a high-temperature environment.
- Plastic film can be dangerous, please keep away from babies and children.
- Please unplug the charger from the electrical socket when not in use.
- Do not use a battery pack that is damaged.
- Do not block the air inlet or air outlet in case of overheating.
- Do not shake cleaner hard in case the dirty water goes into the vacuum motor.
- Please empty it in time when the dirty water tank is full.
- Please ensure the cleaner is upright when moving cleaner in case the dirty water goes into the vacuum motor.

Package Includes



Main Body*1



Handle*1



Li-ion Battery Pack*1



Cleaning Tool*1

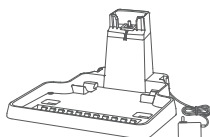

Charging Station*1

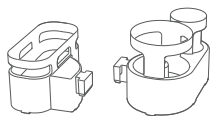

Drying Tray*2

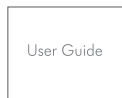

User Guide*1

Note: If you find something missing in your package,
please contact customer support via support@neakasa.com.

Product View

Front View

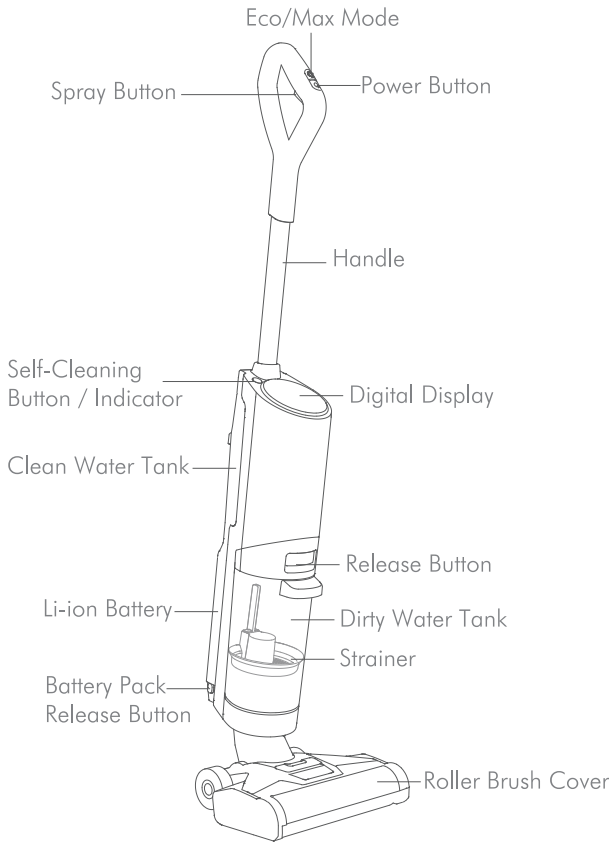

Back View

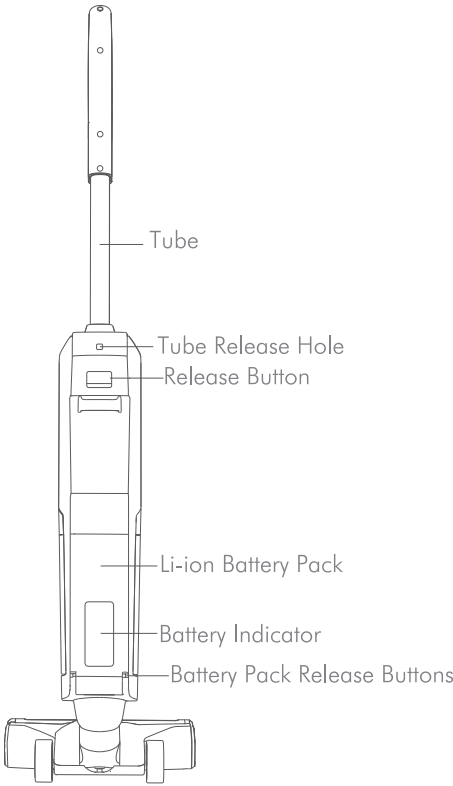

Product View

Clean Water Tank

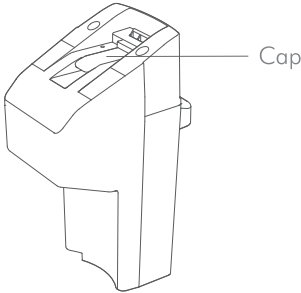

Brush Base

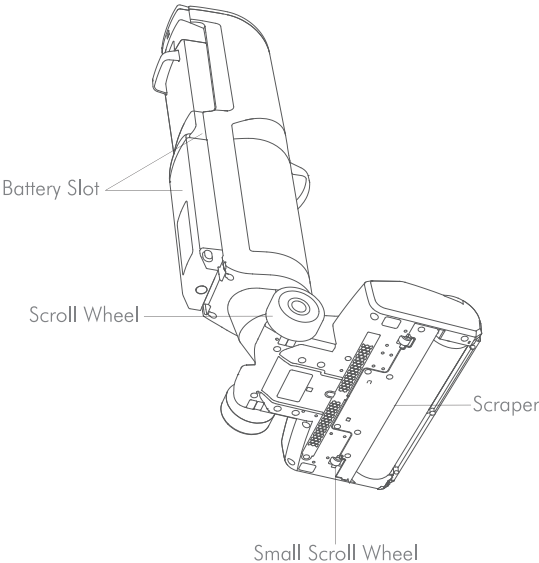

Charging Station

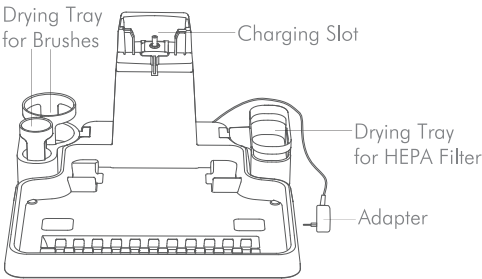

Product View

Digital Display

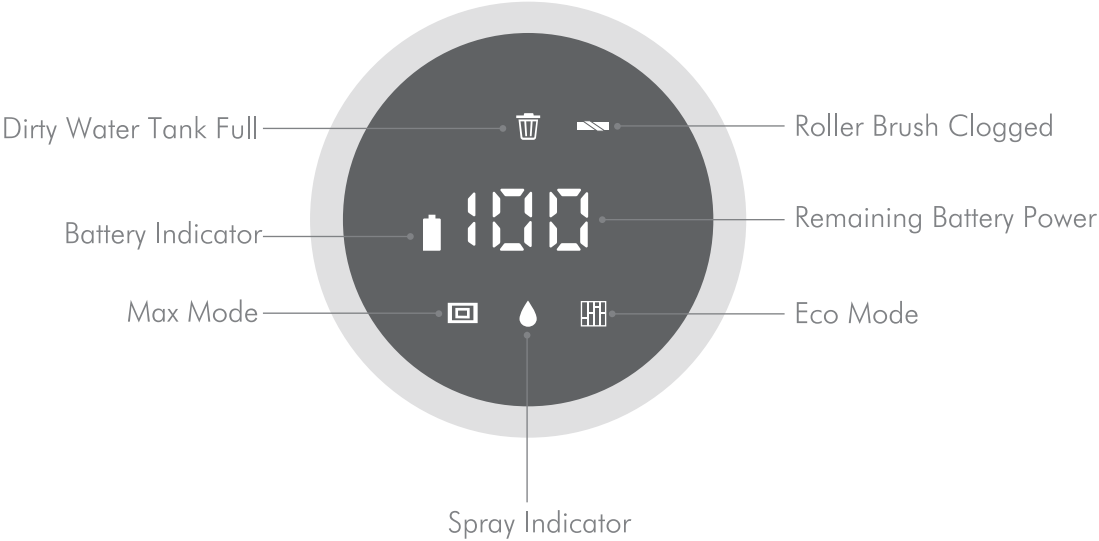

Get Started

Assembling

1. Take out the handle, main body, Li-ion battery pack, clean water tank, dirty water tank set, roller brush, charging station, drying tray, cleaning tool from the package.

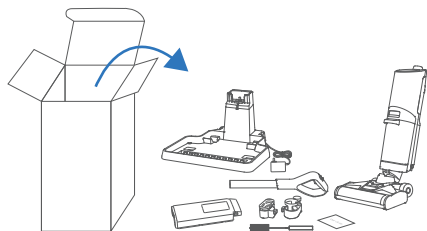

2. Insert the handle into main body of the cleaner until you hear a click.



3. Put the battery into the groove and push it upward. Hearing a click indicates that it is correctly fixed.

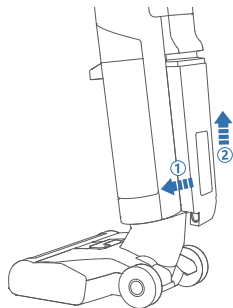

4. Place the charging station near the wall. Insert the drying trays into the charging station.

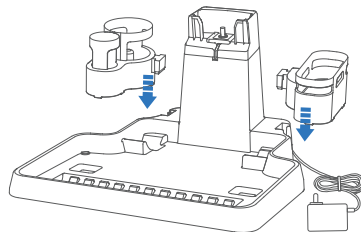

Get Started

Charging the Cleaner

Option 1:

Put the cleaner on the charging station and plug the adapter into a wall outlet. The cleaner will start charging.

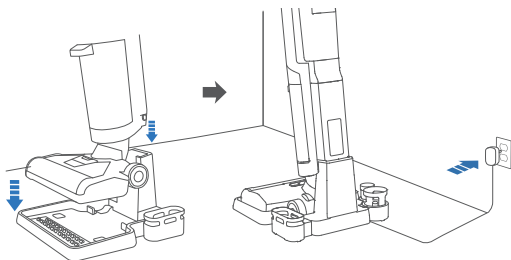

Option 2:

Remove the Li-ion battery pack from the main body and charge it directly.

Please refer to the battery assembly instructions for the battery disassembly.

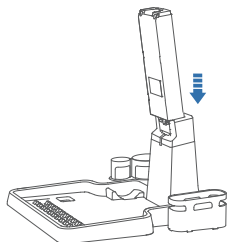

Battery Indicator:

Charging: The battery indicator flashes WHITE; the remaining battery power will appear on the digital display

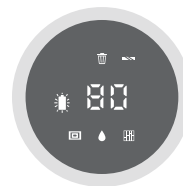

Fully Charged: The battery indicator stays on; the battery power reaches 100% on the digital display



After the cleaner is fully charged, please disconnect the power supply.

Notes:

- Please charge the cleaner for 12 hours for the first time, or ensure at least 6 hours charging for max running time.
- For a longer battery lifespan, do not charge the cleaner every time it nearly runs out of power.

Get Started

Filling up the Clean Water Tank

1. The clean water tank is located on the back of the main body. Press the release button and pull it outwards to remove it.



2. Open the tank cap and add some water under 140°F/60°C.

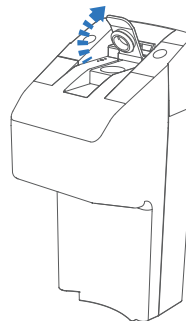

3. Close it and insert the clean water tank into the cleaner.

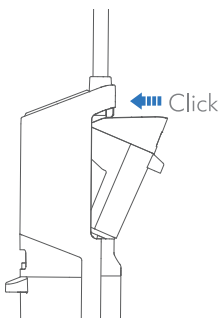

Notes:

- Do not tighten the cap too tightly or too loosely, otherwise the cover may be damaged or the water tank may leak.
- You can also add some non-corrosive cleaning solutions for deep cleaning; do not add dirty water to the cleaning water tank.
- It is normal if there is water in the water tank on first use. Tests and inspections are proceeded before products leave the factory.

Get Started

Cleaning Floor with the Cleaner

1. Check the handle, clean water tank, dirty water tank, Li-ion battery pack and roller brush. Make sure all of them are installed correctly and tightly.

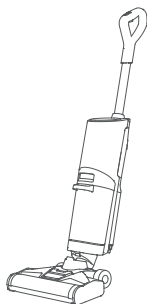

2. Press down the brush base with a foot and hold the handle backward. This step is a must to operate the cleaner.

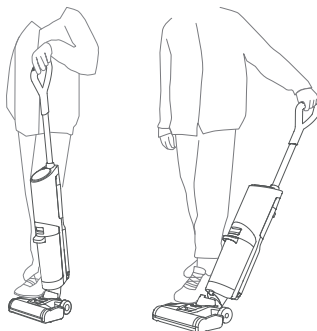

3. Press the power button and the cleaner will start in Eco mode by default. Press it again to turn off the cleaner. Press the Eco/Max Mode button to switch the suction power. The corresponding icon will appear on the digital display.

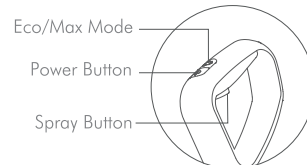

4. Hold the spray button for 8 seconds to prime the cleaning water/solutions before each use. Spray water according to your personal use during cleaning.



Notes:

- Put the cleaner upright and it will automatically power off.
- The angle range of handle tilt must be within 60.5 degree(up and down). Please do not shake it in use.
- Please clean the dirty water tank after each use.

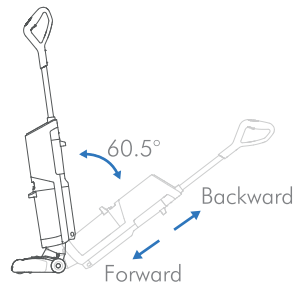

Get Started

Self-Cleaning

The cleaner can clean the roller brush and pipeline automatically on Charging Station:

- 1). Please make sure there is enough clean water in the clean water tank. Empty the dirty water tank before self-cleaning.
- 2). Place cleaner on the charging station① and plug in the adapter.
- 3). Press the Self-Cleaning button②, and the indicator② will light up. The cleaner will spray the clean water to clean the roller brush and pipeline automatically. Meanwhile, it will vacuum the dirty water into the dirty water tank.
- 4). Please unplug the adapter and clean the dirty water tank once the self-cleaning is finished to avoid getting stinky.

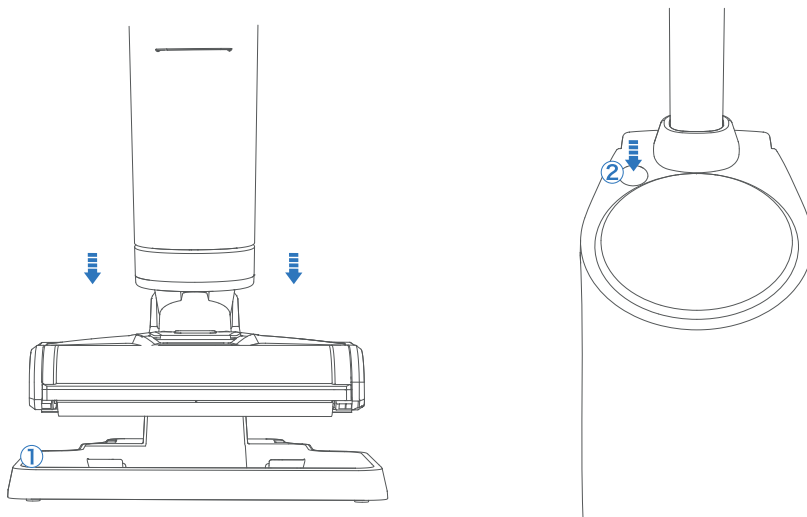

Note: The self-cleaning mode can only be activated when the cleaner is on the charging station.

Care and Maintenance

Please disconnect the power supply, turn off the cleaner, and remove the battery pack before care and maintenance.

General Cleaning

For daily care and maintenance, use a soft dry mop to wipe the main body; use a soft moist cloth to wipe the brush base and scraper.

Dirty Water Tank

1). Press the release button on dirty water tank to remove the dirty water tank from the main body.

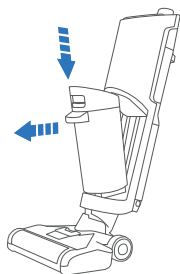

2). Pull up the tank cover to open the dirty water tank. Remove the HEPA filter from the tank cover.

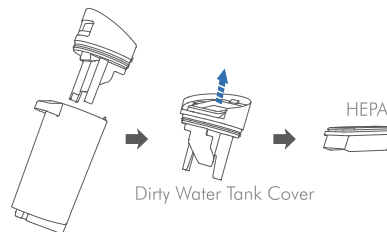

3). Pull up the strainer and pour the debris into the dustbin; pour the dirty water into washbasin.

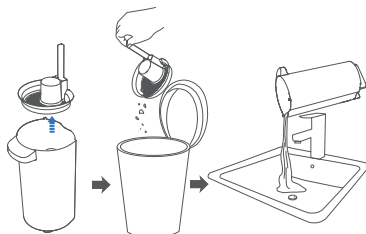

4). Rinse the dirty water tank, tank cover and the HEPA filter with clean water. Completely Dry the HEPA filter on the drying tray.

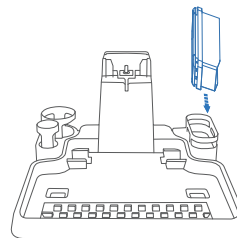

Care and Maintenance

Roller Brush

1). Press the release button on the roller brush cover.

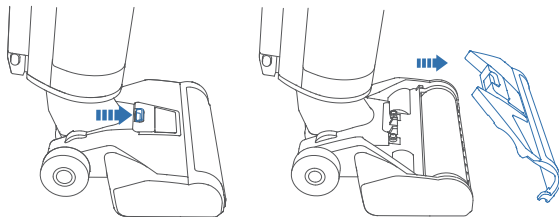

2). Pull the head of the roller brush to take it out.

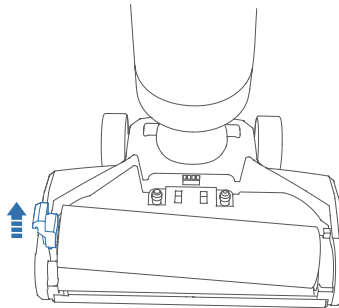

3). Clean the brush and brush cover with a cleaning tool.

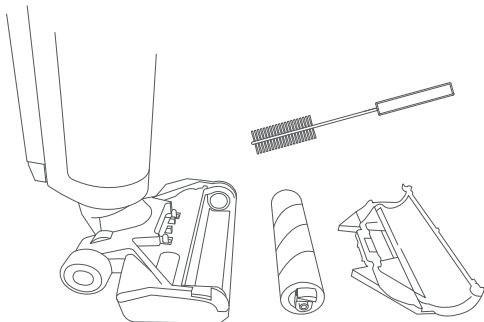

4). Completely dry the roller brush on the drying tray.

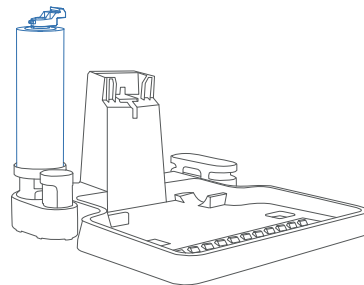

Care and Maintenance

Charging Station & Drying Tray

1). Disconnect the power supply and take the main body out before cleaning.

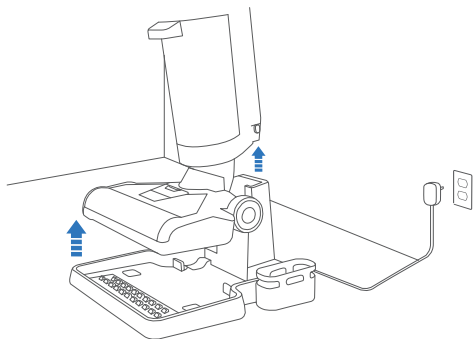

2). Pour out the dirty water in the charging station. Wipe the charging station and drying trays with a soft dry mop.

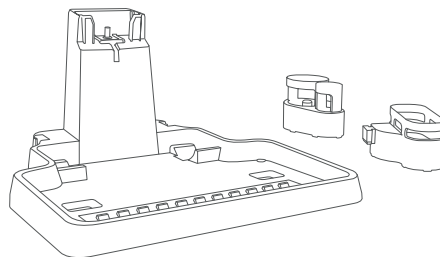

Care and Maintenance

Storage & Re-installation

- 1). The roller brush, cleaning tool and HEPA filter can be stored in the drying tray.
- 2). Please reinstall the clean water tank, dirty water tank, roller brush cover, HEPA filter after completely dried.

Notes:

- The dirty water tank must be cleaned and dried after every single cleaning to avoid mildew or smell.
- The machine must be stored in a dry and ventilated place without heat sources.
- Please keep the machine away from the direct sunlight.
- The battery pack should be fully charged at least once every 3 months to avoid damage to the battery.

Care and Maintenance

Cleaning / Replacement

Frequency Recommended

Part	Cleaning / Replacement Frequency Recommended
Clean Water Tank	Empty if not used for a long time.
Dirty Water Tank	Cleaning after each use.
HEPA	Cleaning after each use; Replace every 3-6 months.
Roller Brush Cover	Cleaning after each use.
Roller Brush	Cleaning after each use; Replace every 3-6 months.
<div>Notes:<ul style="list-style-type: none">• The suction power can be reduced if the HEPA filter is not replaced for a long time.• The above frequency is only for your reference. The actual cleaning/replacement frequency should depend on the usage.</div>	

Disposal of Battery

When disposing of the device, please remove the battery from the device first. Do not put the batteries together with household waste. Please send the batteries to the local authoritative recycling center for correct disposal.

Specifications

Product Model	HN0080W
Size of Main Unit	310*320*1130mm
Net Weight	≈4.2kg
Input	35V 0.5A
Rated Power	350W
Battery Type	Li-ion Battery
Battery Capacity	3000mAh
Battery Voltage	28.8V
Clean Water Tank Capacity	780 ml
Dirty Water Tank Capacity	700 ml
Working Time	30 mins (Eco Mode); 20 mins (Max Mode)
Charging Time	≈6 hours
Working Mode	Eco Mode / Max Mode

Troubleshooting

If you cannot find the answer below, please contact us via support@neakasa.com

Problems	Possible Reasons	Solutions
Cleaner can not be charged.	<ul style="list-style-type: none">• The power supply does not connect well.• Cleaner isn't connected well with charging station.	<ul style="list-style-type: none">• Check the connection of power supply.• Adjust and place the cleaner on the charging station again.
The handle control doesn't work.	<ul style="list-style-type: none">• The battery power is low.• The handle doesn't connect well.	<ul style="list-style-type: none">• Check the battery power and fully charge it.• Rre-install the handle.
Cleaner doesn't work.	<ul style="list-style-type: none">• The dirty water tank is full.• The dirty water tank is not installed.• The roller brush is not installed.• The cleaner runs out of power.	<ul style="list-style-type: none">• Empty the dirty water tank.• Check and install the dirty water tank.• Check and install the roller brush.• Charge the cleaner.
The vacuum is getting weaker.	<ul style="list-style-type: none">• The HEPA is blocked.• The HEPA is wet.• The Scraper is not installed well.	<ul style="list-style-type: none">• Check and clean the HEPA.• Dry the HEPA first.• Check and re-install the scraper.

Troubleshooting

Problems	Possible Reasons	Solutions
The clean water tank seems to be leaking.	<ul style="list-style-type: none">• The clean water tank is not installed well.• The cap is not tightened well.• The outer surface got wet when added water.	<ul style="list-style-type: none">• Re-install the water tank.• Tighten the cap well.• Wipe and dry the outer surface.
No water comes out when spraying.	<ul style="list-style-type: none">• The clean water tank is empty.• The clean water tank is not installed well.	<ul style="list-style-type: none">• Fill up the clean water tank.• Re-install the clean water tank.
Cleaner doesn't work in self-cleaning mode.	<ul style="list-style-type: none">• Cleaner isn't connected with power supply.• The dirty water tank is full.• Lack of water.	<ul style="list-style-type: none">• Please check and connect with the power supply well.• Please empty the dirty water tank.• Please fill up the clean water tank.
Cleaner doesn't move smoothly.	<ul style="list-style-type: none">• The roller brush isn't installed well.	<ul style="list-style-type: none">• Please check and re-install the roller brush according to the instructions.

Customer Support

If you have other questions or comments about your product,
please contact us via support@neakasa.com or our Facebook [@neakasa.tech](https://www.facebook.com/neakasa.tech).